

ARTINOX

## LAYER BRL 50

PRO  
Workstation Sinks

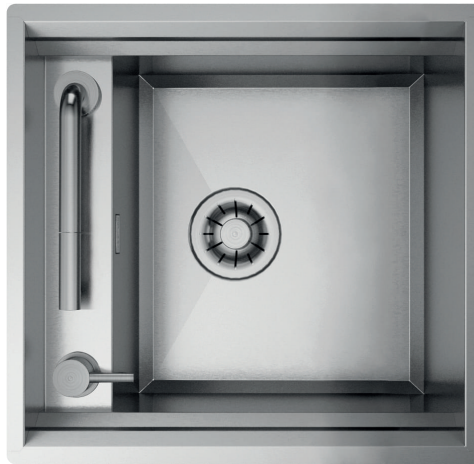

### Installations

Undermount

### Code

SBBRL050

### Description

An essential and functional aesthetics thanks to the wide depth which improves the capacity. Everything is kept inside the sink and each accessory perfectly slides aligned with the worktop.

### Accessories included

### Technical details

Material	AISI 304
Finishing	Brushed
Internal radius	welded at a 90-degree
External dimensions	corners
Basin dimensions	540 x 510 mm
Basin depth	420 x 410 mm
Drain	230 mm
Base	inox Plus 3 ½"
	600 mm

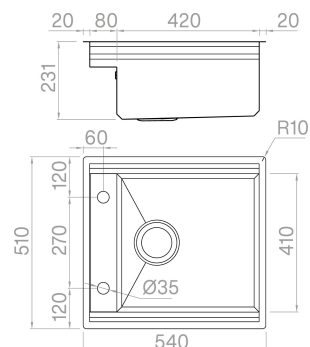

Artinox SpA reserves the right to modify the characteristics of the products at any time. Technical data, illustrations and information are non-binding. Artinox SpA is not responsible for any mistakes of illustrations, text and/or translations.